

The recently revitalised Threlkeld Village Hall is an ideal venue for your event.

Major advantages are:

- * a prime location with spectacular views in an attractive and popular part of the Lake District
- * top quality facilities
- * clients can make their own catering arrangements
- * AV facilities
- * Stage and stage lights
- * licensed for sale of alcohol
- * Coffee Shop open 10-5pm daily (10 – 4pm Winter) providing coffee, tea, soft and alcoholic drinks, cakes, scones, sandwiches and soups.



Want to Book?

Full details of how to book and charges (standard and local rates) can be viewed online at <http://threlkeldvillagehall.org/hire-the-village-hall>; or email bams@btconnect.com for information, or phone 07563 619358.

HOW TO FIND THRELKELD VILLAGE HALL

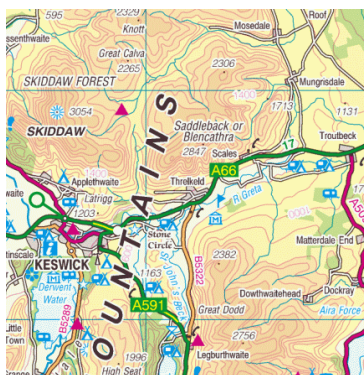

By car - Drive into Threlkeld from the turn off the A66 at either end of the village. The Village Hall is towards the Keswick end of the village. There is a car park (subject to availability) including space for disabled drivers, and other places to park in the vicinity.

By bus - The X4/X5 Keswick-Penrith service stops outside the Village Hall.

Walking or cycling - Threlkeld Village hall is on the C2C national cycle route.



Issued 03 August 2018

THRELKELD VILLAGE HALL



Ideal for classes, meetings, parties, funeral teas, films, music events, theatre productions, wedding receptions and as a camping barn

FACILITIES AT THELKELD VILLAGE HALL

Main Hall

- Approx. 14m by 7m
- Can accommodate up to 100 seated at tables and up to 120 theatre style.
- Quality wooden floor
- Up to 120 chairs
- Up to 10 Large folding tables (1.8m by 0.75m)
- Up to 16 Small folding tables (0.9m by 0.75m)
- Up to 5 large round tables (1.5m diameter) so seat 8-10 people
- Platform staging up to 18m² by prior arrangement and erected and dismantled by us.
- AV system with microphone, DVD player, projector & screen with connections for laptops, ipods, phones.
- WiFi throughout the building
- Stage Lights
- Exercise mats and mirrors for dance/exercise groups.
- 5 Sound screens which can be used to divide the space

Meeting Room after 5:30pm

This area operates as a Coffee Shop from 10 to 5pm daily (10am – 4pm in Winter) serving light meals and cakes as well as a range of drinks.

- Approx. 9m x 5.5m
- Will seat 40 people depending on layout, but ideal for meetings of up to 20.
- Portable digital projector and screen by prior arrangement
- Beautiful views to Clough Head and St John's in the Vale
- Windows opening onto a small veranda.

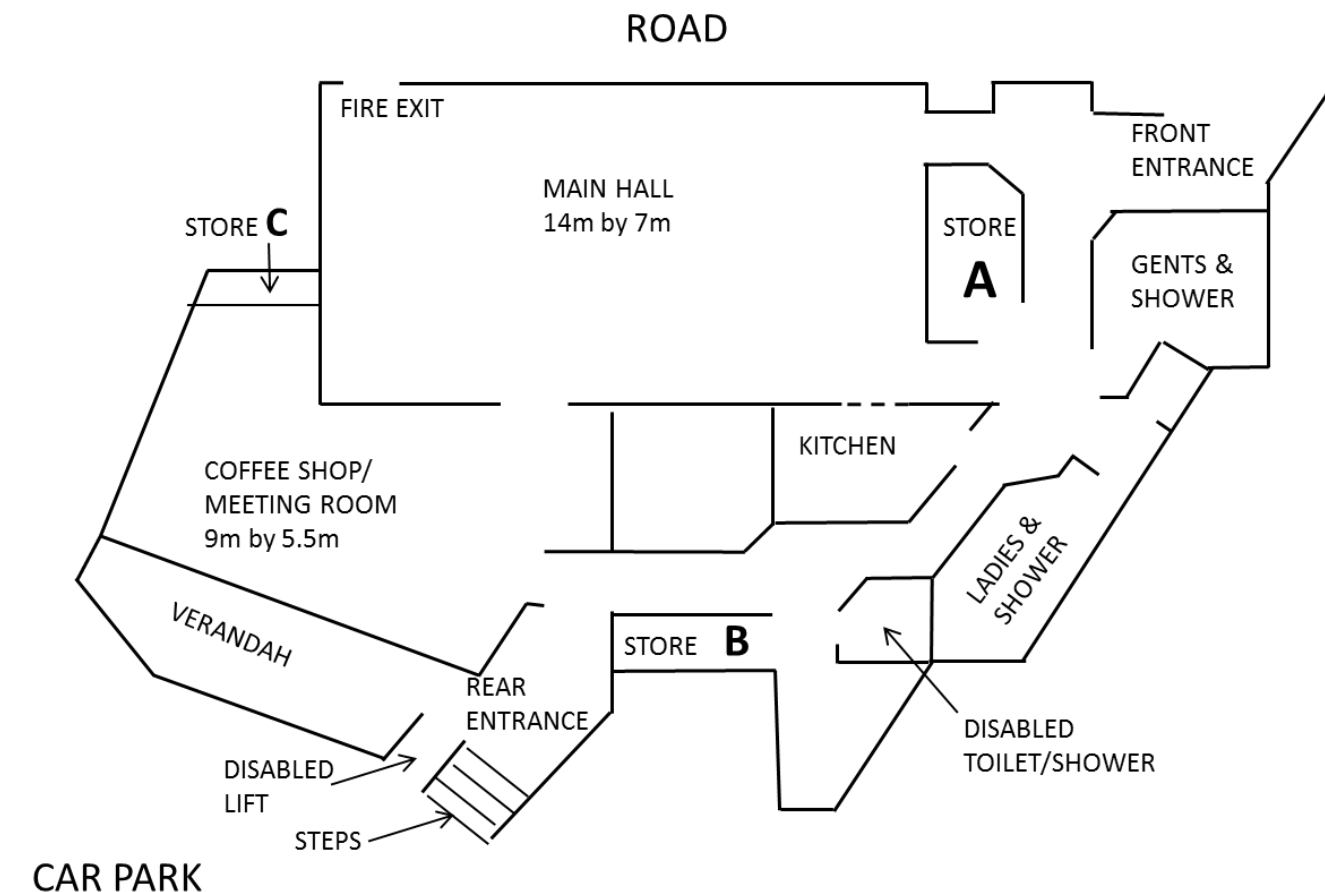

Kitchen

- six hob electric cooker with 2 ovens
- countertop grill and 1500W microwave
- full height fridge and separate freezer
- "hot cupboard" on castors and steel trolley
- dishwasher and washing machine
- kettles and a water boiler
- crockery and cutlery
- pans, dishes and utensils
- polycarbonate pint, half pint and wine glasses

Toilets and Showers

The Gents and Ladies toilets also include a shower cubicle. A disabled toilet/wet room also incorporates an accessible shower area and baby changing facilities.

Heating

The whole building has been insulated to very high levels, and is heated by zone controlled underfloor heating, powered by ground source heat pumps and PV cells.